

THE CITY OF NAPOLEON

BUILDING & ZONING DEPARTMENT

255 W. RIVERVIEW

(419)592-4010

Building Permit

Permit Number: BP2006-133

Page 1 of 1

Printed: 10/2/2006

ADDRESS:

966 Clairmont Ave.

Applicant

Name: Virgil Behls

Address: 966 Clairmont Ave

Approval Date: 10/2/2006

419-592-9471

Owners

Name: Mr. Virgil Behls Jr.

Address: 966 Clairmont Ave

Napoleon, OH 43545

Phone: 419-592-9471

Contractors

Fees and Receipts:

Number	Description	Amount
FEE2006-449	Shed	\$5.00

Total Fees: \$5.00

RCPT2006-259		\$5.00
--------------	--	--------

Total Receipts: \$5.00

replacing existing shed

APPLICANT'S SIGNATURE:

Virgil P. Behls Jr.

DATE:

10/2/06

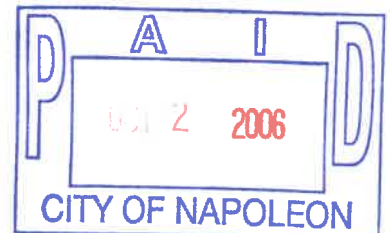

CITY OF NAPOLEON GENERAL PERMIT APPLICATION

THIS APPLICATION IS FOR RESIDENTAL CONSTRUCTION INCLUDING BUILDING, ELECTRICAL, PLUMBING, MECHANICAL, DEMOLITIONS, REMODELING.

DATE: 10/2/06 JOB LOCATION: 966 Clairmont Ave

OWNER: Virgil P. Bohls Jr. PHONE: 419 592 9471

OWNER ADDRESS: 966 Clairmont Ave CITY: Napoleon ZIP: 43545

CONTRACTOR: self

PHONE #: _____ CELL PHONE# _____

CONTRACTOR LICENSED WITH THE CITY OF NAPOLEON?: YES NO:

Is any of the above job going to be subcontracted out? Yes No:

If yes to whom: _____

DESCRIPTION OF WORK TO BE PERFORMED: Build Storage Shed

ESTIMATED COMPLETION DATE: 12/06

PLEASE MARK THE TYPE OF WORK YOU WILL BE PERFORMING

- | | |
|---|---|
| <input type="checkbox"/> A/C ADD ON | <input type="checkbox"/> REMODELING |
| <input type="checkbox"/> BOILER REPLACEMENT | <input type="checkbox"/> ROOFING |
| <input type="checkbox"/> CURBING | <input type="checkbox"/> SEWER REPAIRS** |
| <input type="checkbox"/> DECKS * | <input type="checkbox"/> SIDEWALK* |
| <input type="checkbox"/> DRIVEWAY* | <input type="checkbox"/> SIDING |
| <input type="checkbox"/> ELECTRICAL SERVICE UPGRADE | <input checked="" type="checkbox"/> STORAGE SHED* |
| <input type="checkbox"/> ELECTRICAL SERVICE NEW | <input type="checkbox"/> SWIMMING POOL* |
| <input type="checkbox"/> FENCE* | <input type="checkbox"/> FURNACE REPLACEMENT |
| <input type="checkbox"/> ADDITIONS* | <input type="checkbox"/> TEMP ELECTRIC |
| <input type="checkbox"/> FURNACE NEW | <input type="checkbox"/> WATER TAP (size _____") |
| <input type="checkbox"/> LAWN METER | <input type="checkbox"/> WINDOWS |
| <input type="checkbox"/> PLUMBING | <input type="checkbox"/> ZONING |

*PLEASE INCLUDE A PICTURE SHOWING MEASUREMENTS FROM EXISTING STRUCTURES AND PROPERTY LINES. INDICATING THE TYPE OF WORK YOU WISH TO PERFORM.

** IF WORK REQUIRES GOING INTO THE STREET A STREET BOND IS REQUIRED!

FOR PERMIT COSTS PLEASE FILL OUT REVERSE SIDE

PERMIT COST WORKSHEET

<u>JOB</u>	<u>BASE FEE</u>	<u>TOTAL</u>
SIDING (only) TOTAL SQ _____ X 1.00 +	\$5.00 =	\$ _____
ROOFING (only) TOTAL SQ _____ X 1.00 +	\$5.00 =	\$ _____
WINDOWS / DOORS(only) # ____ X 1.00 +	\$5.00 =	\$ _____
ELECTRICAL # OF CIRCUITS _____ X 3.00 +	\$15.00 =	\$ _____
ELECTRICAL SERVICE UPGRADE	\$15.00 =	\$ _____
PLUMBING (INSIDE) replacing/ repairs	\$10.00 =	\$ _____
SEWER (OUTSIDE)	\$25.00 =	\$ _____
WATER HEATER	\$5.00	\$ _____
SHED UNDER 200 SQ FT (over 200 see chart)	\$ 5.00	\$ _____
FURNACE OR A/C (REPLACEMNT)	\$ 5.00	\$ _____
DEMOLITION (only)	\$30.00	\$ _____
SIDEWALK REPLACEMENT/ NEW	\$25.00	\$ _____
DRIVEWAY	\$25.00	\$ _____

ALL CONSTRUCTION, ALTERATIONS, REMODELING, SHEDS, DECKS & FENCES NOT LISTED ABOVE IS BASED ON COST OF WORK BEING PERFORMED.

COST OF WORK \$ _____ (SEE CHART) \$ _____

0.00	-	250.00	0.00	11,000.00	-	11,999.00	25.00
250.00	-	1,000.00	10.00	12,000.00	-	12,999.00	26.00
1,000.00	-	1,999.00	12.00	13,000.00	-	13,999.00	27.00
2,000.00	-	2,999.00	14.00	14,000.00	-	14,999.00	28.00
3,000.00	-	3,999.00	16.00	15,000.00	-	15,999.00	29.00
4,000.00	-	4,999.00	18.00	16,000.00	-	16,999.00	30.00
5,000.00	-	5,999.00	19.00	17,000.00	-	17,999.00	31.00
6,000.00	-	6,999.00	20.00	18,000.00	-	18,999.00	32.00
7,000.00	-	7,999.00	21.00	19,000.00	-	19,999.00	33.00
8,000.00	-	8,999.00	22.00	20,000.00	-	20,999.00	34.00
9,000.00	-	9,999.00	23.00	21,000.00	-	21,999.00	35.00
10,000.00	-	10,999.00	24.00	22,000.00	-	22,999.00	36.00
				Over 22,999		Please Call	

*OTHER FEES NOT LISTED MAY APPLY

Boer Property Line

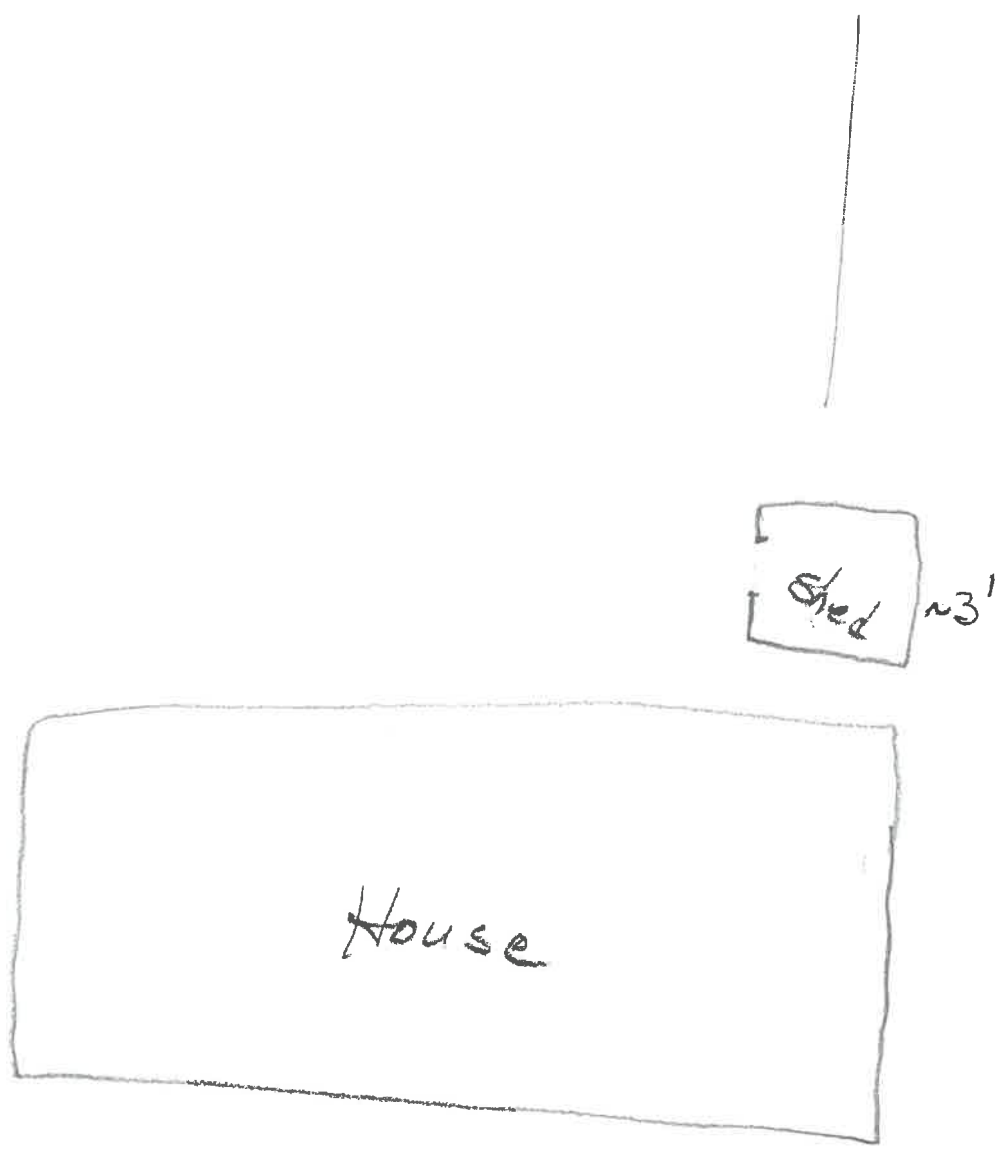

CITY OF NAPOLEON

By: _____

Title: _____

STATE OF OHIO

COUNTY OF _____, SS.

Sworn to before me and subscribed in my presence by _____, _____
_____ of _____, this _____
day of _____, 200____.

(Notary Public)

THE CITY OF NAPOLEON
BUILDING & ZONING DEPARTMENT
255 W. RIVERVIEW
(419)592-4010



Inspections

Page 1 of 1

Address: 966 Clairmont Ave.
Napoleon, OH 43545

Printed: 9/27/2007

Applicant: Virgil Behls

Permit Number: BP2006-133

Inspection Date: 9/27/2007
Inspection Number: INSP2007-264
Inspection Type: Building Final

Inspector: Tom
Status: Complete
Passed?

Required Steps:

Comments:

Other Fields:

